



17th Annual Meeting
Gesellschaft für Biologische
Systematik (GfBS)

Taxa in Time and Space

21–24 February 2016

www.lmu.de/gfbs2016



staatliche
naturwissenschaftliche
sammlungen bayerns



3rd Circular

February 16, 2016

This is the **third circular** for the 17th Annual Meeting of the Gesellschaft für Biologische Systematik. It provides you with **important information** regarding the conference, which can also be found on our website www.lmu.de/gfbs2016.

How to get to Munich

Arriving by (inter)national rail services: The Central Station is close to the conference venue (10 minutes walk) and close to the city center.

Arriving by (inter)national coach services: There is a Central Bus Station in Munich (ZOB) located at 'Hackerbrücke'. From there you can take all suburban trains into the city center in the general direction 'Ostbahnhof, Hauptbahnhof'.

Arriving by plane: Munich has an international airport ([MUC](http://www.munich-airport.de); www.munich-airport.de), which is located NE of the city. From there you can take an airport shuttle [bus](http://www.munich-airport.de/en/consumer/anab/bus/index.jsp) (www.munich-airport.de/en/consumer/anab/bus/index.jsp) or two suburban trains ([S-Bahn](http://www.munich-airport.de/en/consumer/anab/bahn/index.jsp); www.munich-airport.de/en/consumer/anab/bahn/index.jsp) into town (about 50 minutes), line S1 or S8, which depart directly beneath Terminal 1 and will take you to the city center/Central Station (Hauptbahnhof).

How to get to the Conference venue?

Address

Paläontologisches Museum München
Richard-Wagner-Str. 10
D-80333 München

The location is close to the **Munich Central Station (Hauptbahnhof München)**; from there you can either use public transport (see below) or walk to the venue (~10-15 minutes).

By public transport

- underground line **U2** (stop **Königsplatz**) or lines **U1, U7** (stop **Stiglmaierplatz**),
- bus line **100** (stop **Königsplatz**),
- tram lines **20, 21, 22** (stop **Stiglmaierplatz**)

For tickets, prices and timetables visit [MVG](http://www.mvg.de/en.html) (www.mvg.de/en.html).

By car

It is not recommended to drive to the venue, as on-site parking is not available and public parking is limited and expensive. In case you cannot avoid driving in, the best chance to find parking spaces is on Luisenstrasse (see map below).



Registration

The conference office will be open on **Sunday 21st February from 4 pm – 9 pm**, where you can register (Richard-Wagner-Str. 10, 1st floor, room D116). During the conference, the office and registration desk will be open **every day from 8.30 am** and will be closing at times coordinated with the conference programme.

Upon registration, you will receive a conference folder containing the programme, a USB stick containing the Book of Abstracts, your name badge, pad and pen, and other useful information. **If you have outstanding registration fees to pay, please pay these in cash (only EUR can be accepted) at the registration desk.**

We kindly ask you to be prepared for uploading your presentation to the conference notebook at the conference office **preferably on Sunday 21st February** upon registration (however, not later than at the end of the day before your talk) to avoid any delays or technical hiccups.

Floor plan ground floor

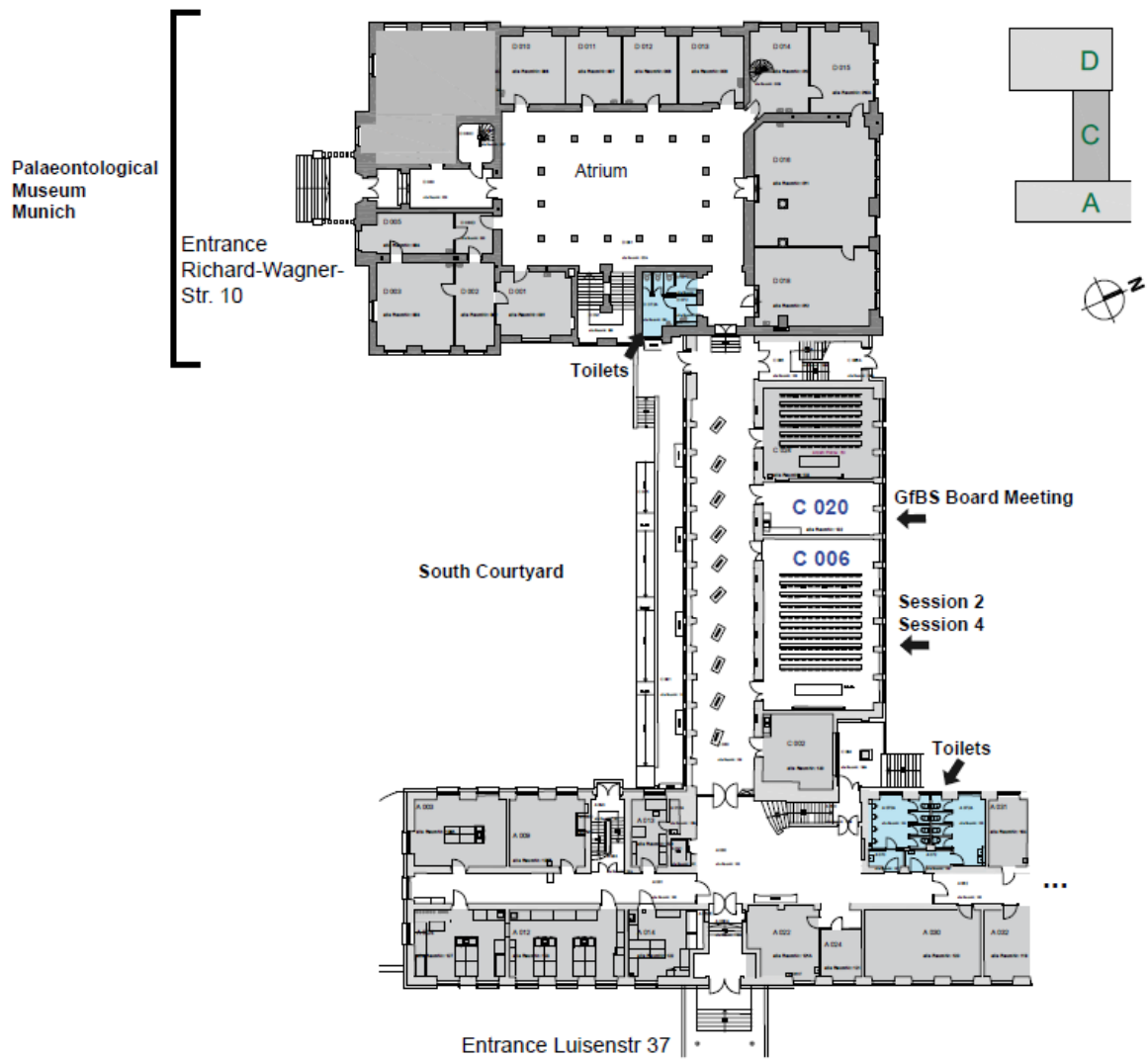

Floor plan first floor



Oral and Poster Contributions

Talks:

The TOTAL time allocated for each oral presentation is **15 min** including questions. **Please load your presentation well in advance either onto the computer in the conference office or onto the notebooks in the lecture halls, preferably on Sunday or during the breaks, so that potential technical issues can be sorted out before the sessions commence.**

Oral presentation are held in room **C006** on the ground floor (session 2 and 4), in room **C106** on the first floor (session 1 and 3), and in room **D114** on the first floor (session 5).

Technical Support:

MacBookPro with Adobe Acrobat Reader, Powerpoint 2011, iWorks, Impress.

Posters:

The maximum poster size is **A0 in portrait** setting. It is of course no problem if your poster slightly exceeds these limits, but we cannot display landscape posters. You can be put up from **Sunday 21st February 5 pm**. Posters will be **displayed throughout the conference** in room **D118** on the first floor. Adhesive materials will be provided; poster boards will be labelled with numbers and a list including numbers, poster authors and titles will be provided. **There will be a dedicated poster session on Monday 22nd February relevant for the Student Poster Prize, and a second session on Tuesday 23rd February; we suggest that authors will be available at their posters during the poster sessions.**

The best **student poster prize** and the best **student presentation prize** will be organised and given by GfBS board members.

Abstracts of all keynote, oral, and poster presentations will be published in **Zitteliana 88**. For the conference, the Book of Abstracts will be available electronically only from the conference web page, but can be ordered as a hard copy on site. The [download](#) is available after 17th February.

Keynote Speakers

The plenary keynotes are 40 minutes long including discussion and take place in room **C106** on the first floor.

[Katrine Worsaae](#): ‘How small animals provide clues to large scale questions’ – Monday 22nd February 9.30 am.

[Gustav Paulay](#) ‘Diversification on coral reefs’ – Monday 22nd February 10.10 am.

[Davide Pisani](#) ‘Are ctenophores really the sister group of all the other animals?’ – Tuesday 23rd February 9.10 am.

[Stacey D. Smith](#) ‘Connecting genetic mechanisms to phylogenetic patterns: Studies of flower color evolution in Solanaceae’ – Tuesday 23rd February 9.50 am.

The **GfBS Board Meeting** takes place on Sunday 21st February 4.00 pm in room **C020** on the ground floor.

The **Icebreaker** takes place on Sunday 21st February from 6.00 pm onwards in room **D105** on the first floor.

Welcome Notes will be held on Monday 22nd February 9.00 am in **C106** on the first floor.

Coffee Breaks take place on Monday 22nd and Tuesday 23rd February in room **D105** on the first floor.

Lunch Breaks: you will be provided with a map of food opportunities in your conference package!

A **Group Picture** will be taken on Monday 22nd February 12.45 pm at the beginning of the lunch break in the Southern courtyard, so please do not run away after the sessions!

'AG Kuratoren' will meet on Monday 22nd February 3.30 pm in **D114** on the first floor.

The **GfBS Annual General Assembly** will be held on Monday 22nd February 6.45 pm in room **C106** on the first floor.

The **Bernhard-Rensch Award Ceremony** will be held during the Annual General Assembly on Monday 22nd February 6.45 pm in room C106 on the first floor.

'AG JuSys' will meet on Tuesday 23rd February 5.15 pm in **C106** on the first floor.

The **Conference Dinner** will be held on Tuesday 23rd February from 7.00 pm onwards on the **first and ground floor** of the Palaeontological Museum. It will be buffet-style including vegetarian options.

Conference Programme

You can access the scientific programme in detail including all abstracts on [ConfTool](#). Note that session chairs are tentative and need to be confirmed.

<u>Date: Sunday, 21/Feb/2016</u>	
16:00-19:00	Board: GfBS Board Meeting Location: <u>C020</u>
16:30-17:30	GUI 1: Guided Tour Palaeontological Museum Meeting Point: <i>Gomphotherium</i>
18:00-21:00	ICE: Icebreaker Party Location: <u>D105</u>

Date: Monday, 22/Feb/2016

9:00- 9:30	WEL: Welcome Notes: Gert Wörheide, Ralf Ludwig, Uwe Fritz, Gerhard Haszprunar Location: C106	
9:30-10:10	KEY1: Keynote Speaker Katrine Worsaae Location: C106 Chair: Haszprunar	
10:10-10:50	KEY2: Keynote Speaker Gustav Paulay Location: C106 Chair: Reich	
10:50-11:30	CB1: Coffee Break Location: D105	
11:30-11:45	S1A: Arthropods Chair: Haug, J. Location: C106 Current views on the early evolution of the insect head revisited <u>Koch, Markus</u>	S2A: Mammals Chair: Pfaff Location: C006 Development of thermogenesis in pouch young of <i>Monodelphis domestica</i> (Didelphidae, Mammalia) and the evolution of endothermy in mammals <u>Giere, Peter</u> ; Jastroch, Martin; Cheng, Yiming; Perocchi, Fabiana; Keipert, Susanne
11:45-12:00	Resolving a super-species complex in the past: 300 million years old “sword tails” as an example <u>Haug, Carolin</u>	Septum by septum to evolutionary history of glirids <u>Weber, Denise</u> ; Schubert, Anne; Ruf, Irina; Kriwet, Jürgen; Pfaff, Cathrin
12:00-12:15	Phylogenetic relationships, divergence times and evolution of host plant use in the weevil tribe Apionini (Apioninae, Brentidae, Coleoptera) Winter, Sven; Friedman, Ariel L.L.; Gottsberger, Brigitte; Astrin, Jonas J.; <u>Letsch, Harald</u>	What is a deer and what is an antler? <u>Rössner, Gertrud E.</u> ; Costeur, Loic; Scheyer, Torsten M.
12:15-12:30	<i>Podisma pedestris</i> (Acrididae) – one species becoming two? <u>Becher, Hannes</u> ; Nichols, Richard A.	Passing the buck in systematics – the case of the water deer (<i>Hydropotes inermis</i>) <u>Schilling, Ann-Marie</u> ; Rössner, Gertrud E.
12:30-12:45	DNA barcoding of orthopterans from Germany, Austria, and Switzerland <u>Hawlotschek, Oliver</u> ; Morinière, Jérôme; Szucsich, Nikola; Caetano-Wyler, Sofia; Lehmann, Gerlind; Lehmann, Arne; Schmidt, Stefan; Glaw, Frank; Hausmann, Axel; Haszprunar, Gerhard	New cervid cytochrome b sequences, new conundrums in cervid systematics <u>Heckeberg, Nicola S.</u> ; Erpenbeck, Dirk; Wörheide, Gert; Rössner, Gertrud E.
12:45-14:15	GROUP PICTURE (10 mins) L1: Lunch Break	
14:15-14:30	S1B: Arthropods Chair: Raupach Location: C106 Cryptic lineages in DNA barcoding and how to assign them to classical morphology <u>Spelda, Jörg</u>	S2B: Gastropods Chair: Jörger Location: C006 Incipient hybrid speciation of door snails in previously glaciated areas in the Caucasus Koch, Eva L.; Neiber, Marco T.; Walther, Frank; <u>Hausdorf, Bernhard</u>
14:30-14:45	Taxonomic study of <i>Oedothorax</i> , a hopeful dwarf spider genus for investigating the evolution of sexual dimorphic male head structures <u>Lin, Shou-Wang</u> ; Lopardo, Lara; Uhl, Gabriele	Evolutionary organ pipes in full blast: Do snails dance to the Hutchinson tune? <u>Krings, Wencke</u> ; Glaubrecht, Matthias

14:45-15:00	<p>Does the Mid Atlantic Ridge affect the distribution of benthic isopod crustaceans across the Atlantic Ocean? <u>Bober, Simon</u>; Riehl, Torben; Brix, Saskia; Heitland, Nele; Brandt, Angelika</p>	<p>Morphological adaptations to freshwater habitats in the circulatory and excretory systems of the limnic slug <i>Acochlidium</i> (Acochlidia, Panpulmonata, Gastropoda) <u>Neusser, Timea Pamela</u>; Biging, Anja; Schrödl, Michael; Jörger, Katharina Maria</p>
15:00-15:15	<p>A new phylogeny of copepod (Crustacean) orders based on 18S rDNA <u>Khodami, Sahar</u>; Martinez Arbizu, Pedro</p>	<p>A new superfamilial taxon of heterobranch snails, and implications for the euthyneuran gastropod tree of life <u>Brenzinger, Bastian</u>; Kano, Yasunori; Schrödl, Michael</p>
15:15-15:30	<p>Comparative Morphology of the Mouthparts of Lophogastrids <u>Laufer, Philipp Karl Erich</u>; Maas, Andreas; Mayer, Gerd; Waložek, Dieter</p>	<p>The worms among the gastropods: phylogeny and evolution of Rhodopomorpha (Heterobranchia, Gastropoda) <u>Jörger, Katharina M.</u>; Brenzinger, Bastian; Wilson, Nerida G.; Worsaae, Katrine; Schrödl, Michael</p>
15:30-16:00	<p>AG1: AG Kuratoren Location: D114</p>	
15:30-16:15	<p>CB2: Coffee Break Location: D105</p>	
16:15-16:30	<p>S1C: Marine Invertebrates Chair: <i>Erpenbeck</i> Location: C106</p> <p>Mobile genetic elements in sponge mitochondria: vertical transmission, independent colonization, and consequences for systematics <u>Schuster, Astrid</u>; Becking, Leontine E.; Lopez, Jose V.; Pomponi, Shirley A.; Kelly, Michelle; Lavrov, Dennis V.; Wörheide, Gert; Erpenbeck, Dirk; Cárdenas, Paco</p>	<p>S2C: Fish Chair: <i>Husemann</i> Location: C006</p> <p>A digitalisation project on four major fish collections at the Bavarian Natural History Collections reveals differences in data patterns determined by historical, domain-specific and preservation-related parameters <u>Weibulat, Tanja</u>; Ebert, Martin; Kölbl-Ebert, Martina; Moser, Markus; Neubacher, Dieter; Neumann, Dirk; Obermaier, Henriette; Reichert, Wolfgang; Sanz, Veronica; Weiss, Markus; Triebel, Dagmar</p>
16:30-16:45	<p>A DNA-barcoding inventory of Red Sea calcareous sponges (Porifera, Calcarea) <u>Voigt, Oliver</u>; Erpenbeck, Dirk; Gonzalez Pech, Raúl; Al-Aidaros, Ali M.; Berumen, Michael L.; Guirguis, Adel Naguib; Paulay, Gustav; Wörheide, Gert</p>	<p>Habitat partitioning of two fish species from the Middle Triassic of the Monte San Giorgio (Canton Ticino, Switzerland) <u>López-Arbarello, Adriana</u>; Bürgin, Toni; Furrer, Heinz; Stockar, Rudolf</p>
16:45-17:00	<p>Morphology and phylogeny of Chaetognatha: evaluation of newly discovered and traditionally used characters <u>Müller, Carsten H.G.</u>; Perez, Yvan; Harzsch, Steffen</p>	<p>Hybridisation capture targeting exons across highly divergent fish species <u>Straube, Nicolas</u>; Li, Chenhong; Moritz, Timo</p>
17:00-17:15	<p>Xenacoelomorpha – from enigmatic turbellarians to kingpins of bilaterian origin <u>Haszprunar, Gerhard</u></p>	<p>Can the morphology of deep sea shark teeth reveal sex and species? (Chondrichthyes, Squaliformes) <u>Flammensbeck, Christina K.</u>; Pollerspöck, Jürgen; Straube, Nicolas</p>
17:15-18:45	<p>POS1: Poster Session Student Prize Location: D118</p>	
18:45-22:00	<p>AGM: GfBS General Assembly Location: C106</p>	

Date: Tuesday, 23/Feb/2016

9:00-9:10	WEL2: Announcements Location: C106		
9:10-9:50	KEY3: Keynote Speaker Stacey D. Smith Location: C106 Chair: <i>Fleischmann</i>		
9:50-10:30	KEY4: Keynote Speaker Davide Pisani Location: C106 Chair: <i>Wörheide</i>		
10:30-11:15	CB3: Coffee Break Location: D105		
11:15-11:30	<p>S3A: Deep Time & Methods Chair: <i>Pisani</i> Location: C106</p> <p>Bayesian divergence dating with phylogenomic data suggests an ancient rapid radiation of animals prior to Snowball Earth <u>Dohrmann, Martin</u>; Wörheide, Gert</p>	<p>S4A: Reptiles Chair: <i>Fritz</i> Location: C006</p> <p>New discoveries and the radiation and faunal replacements in tetanuran theropod dinosaurs during the Jurassic <u>Rauhut, Oliver W. M.</u></p>	<p>S5A: Botany Chair: <i>Fleischmann</i> Location: D114</p> <p>Diversification of big plant genera in space and time: insights from phylogeny, biogeography, morphology and karyotype evolution of the genus <i>Ranunculus</i> Emadzadeh, Khatere; Baltisberger, Matthias; <u>Hörandl, Elvira</u></p>
11:30-11:45	<p>Exploring the paleobiology of Ediacara-type organisms in carbonate environments: The Shibantan Member (South China) and the Khatyspyt Formation (Arctic Siberia) <u>Duda, Jan-Peter</u>; Grazhdankin, Dmitriy; Zhu, Maoyan; Reitner, Joachim</p>	<p>The evolution and diversity of sauropods from the early Middle Jurassic Cañadón Asfálto Formation, Patagonia, Argentina <u>Holwerda, Femke M.</u>; Rauhut, Oliver W.M.; Pol, Diego</p>	<p>Navelseeds in the New World <u>Holstein, Norbert</u>; Chacón, Juliana; Hilger, Hartmut H.; Weigend, Maximilian</p>
11:45-12:00	<p>Paleobiology of a new giant protist-type vendobiont from the Ediacaran Shibantan Member (Southern China) <u>Reitner, Joachim</u>; Duda, Jan-Peter; Zhu, Maoyan</p>	<p>“Using the brain” for phylogenetic and paleobiological inferences in early dinosaurs and sauropodomorphs <u>Bronzati, Mario</u>; Rauhut, Oliver W. M.</p>	<p><i>Senecio</i> L. (Asteraceae-Senecioneae) and the colonization of the Palaearctic from southern Africa <u>Kandziora, Martha</u>; Kadereit, Joachim W.; Gehrke, Berit</p>
12:00-12:15	<p>Exploring the third dimension of the early Cambrian Chengjiang arthropods <u>Liu, Yu</u>; Hou, Xianguang</p>	<p>Integrative taxonomy provides evidence for the species status of the Ibero-Maghrebian grass snake <i>Natrix astreptophora</i> <u>Kindler, Carolin</u>; Pokrant, Felix; Ivanov, Martin; Cheylan, Marc; Geniez, Philippe; Böhme, Wolfgang; Fritz, Uwe</p>	<p>Phylogeny and systematics of <i>Jurinea</i>, a large Eurasian genus of the Cardueae (Compositae) <u>Szukala, Aglaia</u>; Korotkova, Nadja; Gabrielian, Eleonora; Litvinskaya, Svetlana A.; Borsch, Thomas; von Raab-Straube, Eckhard</p>
12:15-12:30	<p>The inclusion of ontogenetic data of fossil and extant species increases the explanatory power of phylogenetic reconstructions <u>Haug, Joachim T.</u></p>	<p>The morphology of the trionychian respiratory apparatus and its phylogenetic implications <u>Lambertz, Markus</u>; Perry, Steven F.</p>	<p>Evaluating the origin of xerophytic leaf characters in SW Asian wild pears (<i>Pyrus</i>, Rosaceae) <u>Korotkova, Nadja</u>; Grünstäudl, Michael; Khachatryan, Anahit; Ghulikyan, Lusine; Sargsyan, Harutyun; Akopian, Janna; Borsch, Thomas</p>
12:30-14:00	L2: Lunch Break		

14:00-14:15	<p>S3B: Marine Invertebrates Chair: <i>Worsaae</i> Location: C106</p> <p>The <i>Limacina helicina</i> (Phipps, 1774) complex: splitting one model organism into three Kohnert, Peter; Laibl, Christina Franziska; Schrödl, Michael</p>	<p>S4B: Reptiles/Gastropods Chair: <i>Rauhut/Neusser</i> Location: C006</p> <p>Conservation genetics of the Northern river terrapin (<i>Batagur baska</i>) breeding project Spitzweg, Cäcilia; Praschag, Peter; DiRuzzo, Shannon; Fritz, Uwe</p>	<p>S5B: Botany Chair: <i>Smith</i> Location: D114</p> <p>LARGE (taxonomic) confusion in MICROscopic organisms – Examples for the need of reliable species determination for a robust taxonomy in dinophytes Kretschmann, Juliane; Elbrächter, Malte; Zinßmeister, Carmen; Gottschling, Marc</p>
14:15-14:30	<p>The potential role of sexual selection for deep-sea diversity Riehl, Torben; Heitland, Nele; Brandt, Angelika</p>	<p>Integrative taxonomy of Southeast Asian snail-eating turtles (Geoemydidae: Malayemys) reveals a new species and mitochondrial introgression Ihlow, Flora; Vamberger, Melita; Flecks, Morris; Hartmann, Timo; Cota, Michael; Makchai, Sunchai; Meewattana, Pratheep; Dawson, Jeffrey E.; Kheng, Long; Rödder, Dennis; Fritz, Uwe</p>	<p>Could tiny dinos take over big waters of the world? – spatial distributions of unicellular dinophytes Žerdoner Čalasan, Anže; Filipowicz, Natalia H.; Owsiany, Pawel M.; Kretschmann, Juliane; Irimia, Ramona-Elena; Gottschling, Marc</p>
14:30-14:45	<p>Phylogenetic, bathymetric and onshore-offshore gradients in NE Atlantic cheilostome Bryozoa Berning, Björn</p>	<p>Monitoring of opisthobranch biodiversity in Indonesia – and its applied aspect Wägele, Heike; Schillo, Dorothee; König, Gabriele M.; Kaligis, Fontje; Bara, Robert A.; Böhringer, Nils; Schäberle, Till F.</p>	<p>Phylogenetic position, metabolic profile, and antibacterial extracts of the Antarctic lichen <i>Himantormia lugubris</i> Beck, Andreas; Kuhn, Veronika; Eisenreich, Wolfgang; Divakar, Pradeep K.; Cabrera Rojas, Cinthya; Cuellar, Mauricio; Quilhot, Wanda; Bechteler, Julia; Gonzalez Rocha...</p>
14:45-15:00	<p>How do adult brachiopods sense light? Furchheim, Nina; Lüter, Carsten</p>	<p>Chloroplast activity and degradation in solar-powered Sea slugs Laetz, Elise Marie; Rühr, Peter; Preisfeld, Gela; Bartolomaeus, Thomas; Wägele, Heike</p>	<p>How to organise, process and archive collection and occurrence data using GFBio services provided by Germany's major natural history and culture collection data repositories Triebel, Dagmar; Grobe, Peter; Güntsch, Anton; Hagedorn, Gregor; Holstein, Joachim; Söhngen, Carola; Weiland, Claus; Weibulat, Tanja</p>
15:00-15:15	<p>From bycatch to main dish! Spines of irregular echinoids as monitors for diversity trends in the deep sea during Cenozoic critical intervals. A pilot study. Wiese, Frank; Nils, Schlüter; Mike, Reich; Jens, Herrle</p>	<p>Kleptoplasts – starch storage factories in solar-powered sacoglossan sea slugs? Moris, Victoria; Laetz, Elise; Wägele, Heike</p>	
15:15-16:00	<p>CB4: Coffee Break Location: D105</p>		

16:00-16:15	S3C: Marine Invertebrates <i>Chair: Paulay</i> Location: C106 Evolutionary and functional implications of gastric caecum diversity among irregular sea urchins (Echinoidea: Irregularia) <u>Ziegler, Alexander</u> ; Kroh, Andreas; Anderson, Owen F.; Miskelly, Ashley; Keesing, John K.; Mooi, Rich	S4C: Gastropods <i>Chair: Schrödl</i> Location: C006 Snails in space: Diversity and distribution patterns underlined by intertidal planaxid gastropods <u>Wiggering, Benedikt</u> ; Glaubrecht, Matthias	
16:15-16:30	Hook-bearing sea cucumbers (Apodida, Echinodermata) – the need for modern and detailed investigations <u>Stegemann, Tanja Rita</u> ; O'Loughlin, P. Mark; Reich, Mike	Early evolution of the gastropod superfamily Cerithioidea and the systematic significance of the shell slit <u>Nützel, Alexander</u>	
16:30-16:45	The neural tube of chordates and the tubular collar cord of enteropneusts: homology or homoplasy? <u>Kaul-Strehlow, Sabrina</u>	Integrative taxonomy and niche partitioning of sympatric "Gibbula" species (Trochidae, Vetigastropoda) <u>Steiner, Gerhard</u> ; Affenzeller, Susanne; Haar, Nicole	
16:45-17:15	CON: Awards and Conclusion Location: C106		
17:15-19:00	AG2: AG JuSys Location: C106	POS2: Poster Session Location: D118	
19:00-22:00	DIN: Conference Dinner		

List of Posters

* indicate student poster prize candidates.

No.	Authors	Title
1*	Pérez-Escobar et al.	Quantification of phylogenetic incongruence between organellar and nuclear genomes
2	Yilmaz et al.	Towards an integrative and comprehensive standard for meta-omics data of collection objects (MOD-CO)
3	Weinberger et al.	Testing the power of the Papillomavirus Episteme
4	Jones et al.	Lettuce (<i>Lactuca</i>) diversity; Eurasia to North America Independent lineage migrations and Allopolyploidization
5	Gemeinholzer	Flower-color evolution within the DYCs (damned yellow Composites)
6	Müller et al.	Outlier loci correlate to precipitation: indications for micro-geographic adaptations at the species' range edge of <i>Geropogon hybridus</i> (L.) Sch. Bip. (Asteraceae)?
7*	Uribe-Holguin et al.	Morphology and anatomy of osmophores in <i>Cycnoches</i> Lindl. (Orchidaceae, Catasetinae) and their utility in phylogenetics
8*	Schuster et al.	A first evaluation of RAD-seq to address phylogenetic questions within demosponges
9	Beckers	Phylogenetic significance of the nervous systems of some basally branching Trochozoa
10	von Döhren & Bartolomaeus	Is there any phylogenetic signal in spermatozoa – a case study from nemerteans
11	von Döhren & Dittrich	Find one, get one free! – The re-description of <i>Lineus acutifrons</i> Southern, 1913 results in two species, one of which is new to science
12	Tilic & Bartolomaeus	Another kind of annelid hook—on the fine structure of sipunculan introvert hooks
13*	Bergmeier et al.	A prickly aplousobranchian mollusc from deep-sea plains: first record of an abyssal acanthomeniid <i>Solenogaster</i> in the North-West Pacific
14*	Schachtl et al.	The invasive freshwater jellyfish <i>Craspedacusta sowerbii</i> – is there only one clone present?
15	Berning et al.	Pleurobrancoidean sea slugs revisited
16*	Kochem et al.	A comparative anatomical study of <i>Dermechinus horridus</i> (Echinoidea: Echinidae) and its echinid relatives
17	Reich et al.	Unusal calcareous ring morphology in molpadid sea cucumbers (Echinodermata)?
18	Kieneke et al.	Integrative re-description of <i>Turbanella hyalina</i> (Gastrotricha: Macrotrichida) as baseline for future phylogeographic studies
19*	Bober & Riehl	A step-by-step guide to the digital stippling method
20	Haug & Haug	Character transformation in mantis shrimps: the rise of 'super-sized' raptorial larvae
21	Haug & Haug	Systematic approaches beyond phylogeny: sharpening our logical tools
22*	Rudolf & Haug	Understanding modes of character transformation: intermediate larval stages of decapod crustaceans as an important source

23*	Wagner et al.	Comparative Trunk Research: SEM studies of bisected proboscides of Pantopoda
24	Hübner et al.	Testing species delimitation with larval morphology: SEM analysis of protonymphon larvae of two closely related pantopods, <i>Pallenopsis patagonica</i> (Hoek, 1881) and <i>Pallenopsis yepayekae</i> Weis, 2014
25*	Rossel & Martínez Arbizu	Rapid identification of meiofauna species (Copepoda:Harpacticoida) using MALDI-TOF MS
26*	Callimici & Haug	Phylogenetic reconstruction by means of the development of morphological characteristics: Polyneopteran insects as an example
27	Mende et al.	Diverse admixture patterns in the <i>Hyles euphorbiae</i> complex (Lepidoptera: Sphingidae): Ambitious Integrative Taxonomy
28*	Wagner et al.	Shifts in ontogeny: Species delineation of fossil and extant tadpole shrimps
29*	Becher & Nichols	What prevents <i>Podisma pedestris</i> 's chromosome races from merging?
30	Decker	Mosaic-like polymorphism in two genera of flat millipedes (Diplopoda: Paradoxosomatidae) in southern Australia caused by multiple glacial refugia?
31	Wagenknecht et al.	Ultrastructure and phylogenetic evaluation of the Tömösváry organ in <i>Craterostigma tasmanianus</i> Pocock, 1902 (Myriapoda: Chilopoda)
32	Müller et al.	The shaft organ of <i>Scutigera coleoptrata</i> (Linné, 1758) (Chilopoda): tracing scolopidia back to ground pattern of Mandibulata?
33*	Steinhoff et al.	Chasing the Unknown: The role of larvae in SE-Asian Odonata taxonomy, with case studies of larva descriptions from Borneo
34*	Steinhoff & Uhl	MicroCT Analysis as a tool for taxonomic research in Odonata
35*	Moritz & Koch	Comparative morphology of the cephalic tentorium in millipedes (Diplopoda)
36*	Schucht & Koch	Comparative morphology of the head kidneys and salivary glands of jumping bristletails (Insecta: Archaeognatha)
37	Wiemers et al.	Climatic niche characteristics of the butterflies in Europe (CLIMBER) – a new database for measuring the response of butterflies to climatic changes
38	Lange et al.	Building-up of a DNA barcode library of aquatic true bugs for Germany
39*	Huber & Haug	New insight into the ontogeny of mesothelan spiders and its impact on character evolution in early araneans
40	Rulik et al.	Status of the German Barcode of Life initiative: first results, outlook and an example for the usage of the reference library
41*	Fritz et al.	Early developmental traits demonstrate deep homologies in two distinct galeomorph sharks
42	Herrera	Endocranial anatomy of a marine crocodylomorpha (Thalattosuchia): a preliminary study
43	Castanera et al.	Geometric morphometric analysis applied to theropod ichnotaxonomy: some examples from the Iberian Peninsula
44	Ihlow et al.	Unexpected lack of genetic and morphological divergence in the widespread tortoise <i>Indotestudo elongata</i> (BLYTH, 1854).
45	Standfuss et al.	Threat or fiction: is the pond slider (<i>Trachemys scripta</i>) really invasive in Central Europe? A case study from Slovenia
46*	Pokrant et al.	Further support for the species status of Ibero-Maghrebian grass

		snakes (<i>Natrix astreptophora</i>) by morphological and osteological findings
47	Hawlitschek et al.	Population genomics of the Pyrenean desman (<i>Galemys pyrenaicus</i>) in the Western Pyrenees
48	Guzmán & Rössner	Mouse-deer (Mammalia, Artiodactyla, Tragulidae) diversity disparity in the past and the present: lessons from fossils
49	Wyrwoll	Archaeotherioiconology

Workshops

Guided Tour Leibniz Supercomputing Centre (LRZ) with demonstration of the Virtual Reality Laboratory.

The Leibniz Supercomputing Centre (LRZ) is the main provider of IT and communication-infrastructure for Munich's universities, and the main computational facility for Munich's research centers. The LRZ hosts the 'Super MUC', one of the world's fastest computers, and hardware for virtualizations. Its 'Center for Virtual Reality and Visualisation' facilitates scientific high-quality visualizations and presentations of virtual 3D worlds.

- Start: 14.30 h
- Meeting point: LRZ Main Entrance.
- Duration: ca. 2 hrs.
- Contact person: Rainer Oesmann
- Maximum number of participants: 15

Diversity Bench Workshop

The workshop addresses researchers who intend to organise, manage and preserve their own biological raw data. They will come in contact with GFBio teams at three of the GFBio collection data centers, learn more about the Diversity Workbench (DWB) and related GFBio services.

- Start: 9.00 h
- Meeting point: Menzinger Str. 67, first floor, room number 1392)
- Duration: until ca. 16.00 h
- Contact person: Dr. D. Triebel, T. Weibulat
- Maximum number of participants: 15
- [further information](#)

Workshop on statistic methods in phylogeny with 'R'

This R workshop will cover the basics of R usage and the R programming language, as well as programming, application of statistical approaches and the development of user adapted scripts. From 10.00-12.00 a basic introduction to R is planned. Those who are already familiar with R can join in the afternoon at 13.00.

- Start: 10.00 h
- Location: Botanical Institute Menzinger Str. 67, Munich
- Duration: until ca. 18.00 h
- Contact person: Dr. Natalie Cusimano

- Maximum number of participants: 20
- Participants must provide own computer with [R](#) and [RStudio](#)
- Please contact Dr. Cusimano (cusimano@bio.lmu.de) indicating your purpose to use R and previous knowledge.

Workshop on the Nagoya Protocol on Access and Benefit-sharing (ABS)

The CETAF Legislation and Regulations Group has just released a 74-pages Code of Conduct & Best Practices for Access & Benefit-Sharing.

- Start: 10.00 h
- Location: Lecture Hall C006
- Duration: until the afternoon
- Contact person: Dr. Peter Giere, Dirk Neumann
- [further information](#)

Guided Tours

Sunday, 21 February 2016

Guided tour Paleontological Museum Munich (PMM)

An icon of evolution: the 'Urvogel' *Archaeopteryx*: The historical importance of *Archaeopteryx* and recent advances in our understanding of this iconic fossil.

- Start: 16.30 h
- Meeting point: *Gomphotherium* (Atrium, PMM)
- Duration: ca. 1 hr
- Contact person: Prof. Dr. Oliver Rauhut

Maximum number of participants: 40

Wednesday, 24 February 2016

Guided tour Zoological State Collection Munich (ZSM)

- Start: 9.30 h
- Meeting point: ZSM Lobby
- Duration: ca. 2 hrs.
- Contact person: Prof. Dr. Gerhard Haszprunar

Guided tour Botanical State Collection Munich (BSM)

- Start: 10.00 h and 14.00 h
- Meeting point: Botanical Institute, Menzinger Str. 67, Munich
- Duration: ca. 2 hrs.
- Contact person: Dr. Andreas Fleischmann
- Please register with Dr. Fleischmann (fleischmann@bsm.mwn.de) in advance.

Guided tour Paleontological Museum Munich (PMM)

A journey through vertebrate evolution with a focus on mammals

- Start: 14.00 h
- Meeting point: *Gomphotherium* (Atrium, PMM)
- Duration: ca. 1.5 hrs.
- Contact person: PD Dr. Gertrud Rößner
- Maximum number of participants: 40

Contact

Conference venue

Department für Geo- und Umweltwissenschaften, Paläontologie & Geobiologie
 GeoBio-Center^{LMU}
 Ludwig-Maximilians-Universität München
 Richard-Wagner-Str. 10
 80333 München
 Germany
 Tel.: +49 (0)89 2180 6602
 Fax: +49 (0)89 2180 6601
 E-Mail: gfbs2016@lrz.uni-muenchen.de

Emergency phone numbers:

Medical emergency: 19 222
 Police: 110
 Fire brigade: 112

Munich Tourist Information:

For tourist information please visit the Munich tourist office.

Taxi Company: +49 89 19 410

Local Organising committee (in alphabetical order)

Monika Brinkrolf (LMU)
 Nicole Enghuber (LMU)
 PD Dr. Dirk Erpenbeck (LMU)
 Jonathan Guzmán (BSPG)
 Nicola Heckeberg (LMU, BSPG)
 Thomas Huber (LMU)
 René Neumaier (LMU)
 Britta Nüske-Illenberger (LMU)
 Marlena Olbrys (LMU, BSPG)
 PD Dr. Mike Reich (BSPG)
 Ann-Marie Schilling (LMU, BSPG)
 Ella Schönhofer (BSPG)
 Philipp Wagner (LMU)

Scientific committee

Prof. Dr. Gerhard Haszprunar (LMU, SNSB, ZSM, GeoBio-Center^{LMU})
 Prof. Dr. Gert Wörheide (LMU, BSPG, GeoBio-Center^{LMU})
 PD Dr. Dirk Erpenbeck (LMU, GeoBio-Center^{LMU})

Dr. Andreas Fleischmann (BSM, GeoBio-Center^{LMU})
Dr. Katharina Jörger (LMU)
PD Dr. Mike Reich (BSPG, LMU, GeoBio-Center^{LMU})

We look forward to seeing you in Munich!

On behalf of the organizing committees,

Prof. Dr. Gert Wörheide (Spokesman GeoBio-Center^{LMU})
Prof. Dr. Gerhard Haszprunar (Director General SNSB)

